



EXPLORE
XPENG G6





Light Lights

INDUSTRIAL AREA ON 240 mi 47% 16:37

Smooth Breathing Followed Speed Music rhythm

Monochrome Duobase

Jason City Electric Dreams

Star Trek Wave Light

Home Navigation Music Phone

XPE

EXPERIENCE

1300 1400 1500

1600 1700 1800

1900 2000 2100

2200 2300 2400



SETTING STANDARDS

Starship-inspired design reflects XPENG's vision to not only push the boundaries of innovation, but commitment to blending technological sophistication with modern aesthetics.

The bold robotic face is framed by the full-width integrated light bar for a futuristic presence, plus the fastback silhouette with long front overhang, short rear overhang, and clean side sculpting delivers coupe-like dynamism.



ALL WHEEL DRIVE (AWD) PERFORMANCE

New for 2026, the AWD Performance variant comes with all Long Range features but with improved performance, accelerating from 0-100 km/h in just 4.13 seconds.

AWD Performance is also available in Black Edition styling, featuring Black 20" alloys and Smoked Grey Badging.



EXTERIOR DESIGN

Starship-inspired design reflects XPENG's vision to not only push the boundaries of innovation, but commitment to blending technological sophistication with modern aesthetics.

The bold robotic face is framed by the full-width integrated light bar for a futuristic presence, plus the fastback silhouette with long front overhang, short rear overhand, and clean side sculpting delivers coupe-like dynamism.

COLORS AVAILABLE

ARCTIC WHITE

SILVER FROST

GRAPHITE GREY

MIDNIGHT BLACK

STELLAR PURPLE



BLACK EDITION

EXCLUSIVE PERFORMANCE
STYLING WITH BLACK ALLOYS
& SMOKED GREY BADGING



SUSPENDED ROOF

The suspended roof enhances the car's dynamic, forward-thinking stance while allowing for a more spacious, airy feel inside. It provides exceptional headroom for both front and rear passengers, merging stylish sophistication with practicality for a more comfortable and open driving experience.

FRAMELESS DOOR & HIDDEN DOOR HANDLE

Frameless doors eliminate obstructions, offering a clearer view and reducing blind spots near the A-pillar, so you can enjoy a more open, unobstructed driving experience.

LED SPOILER

Aerodynamic spoiler with suspended light bar enhances both form and airflow control.



EXCELLENCE DEFINING FEATURES

XPENG is driven by a commitment to smart mobility, seamlessly blending advanced technology with everyday usability. The G6 is built to enhance every journey through intelligent systems engineered for precision, comfort and connectivity,

01

XPILOT ASSIST

Powered by an Intelligent driving chip single Orin, XPILOT ASSIST enhances driving, parking and safety. Benefit from Adaptive Cruise Control, Adaptive Turning Cruise and Auto Lane Change; Enhanced Automatic Parking Assistance with remote parking for difficult spaces, 360 degree camera with transparent chassis; plus, forward, side and rear collision prevention. All comes as standard.

02

Full-Stack Lofic Architecture

Equipped with a front binocular camera and rearview camera, the XPENG Full-Stack Lofic Architecture enhances environmental perception across a wide range of driving scenarios, adapting seamlessly to both light and dark conditions. All while acting as a dashcam for added security.

04

Pet Mode

Keep your furry friends safe and comfortable while you're away from your vehicle. With a message displayed on the centre console to inform passersby's that they're being taken care of.



03

Industry-Leading Sensor Suite

Visual perception range extended by 125% compared to the previous generation, with the ability to recognise and distinguish 49 types of obstacles—both dynamic and static—with precision.

05

Seamless Entry

Using the UWB ultra-wideband smart remote control key, NFC card Key.

06

BATTERY AND POWERTRAIN

Feature advanced lithium-ion phosphate battery systems that ensure efficiency, longevity, and power. The batteries are optimized for maximum energy density and performance with triple-layer battery shield, 4-3-4 design which enhances resistance to impact, fire and thermal runaway.

The G6's powerful electric motor provides smooth acceleration and responsive handling, available in rear-wheel drive (RWD) in Standard Range and Long Range or all-wheel drive (AWD) Performance.

08

ELECTRIC EFFICIENCY

Regenerative Braking: The G6 features regenerative braking, which helps recover energy during braking, improving overall efficiency and extending the vehicle's range.

Zero Emissions: As a fully electric vehicle, the G6 produces no tailpipe emissions, contributing to a cleaner environment.

07

SUSPENSION

Front Double-Wishbone & Rear Five Link Independent Suspension Setup Controls full directional movement of each individual wheel for a smooth ride and agile handling with reduced road vibration.

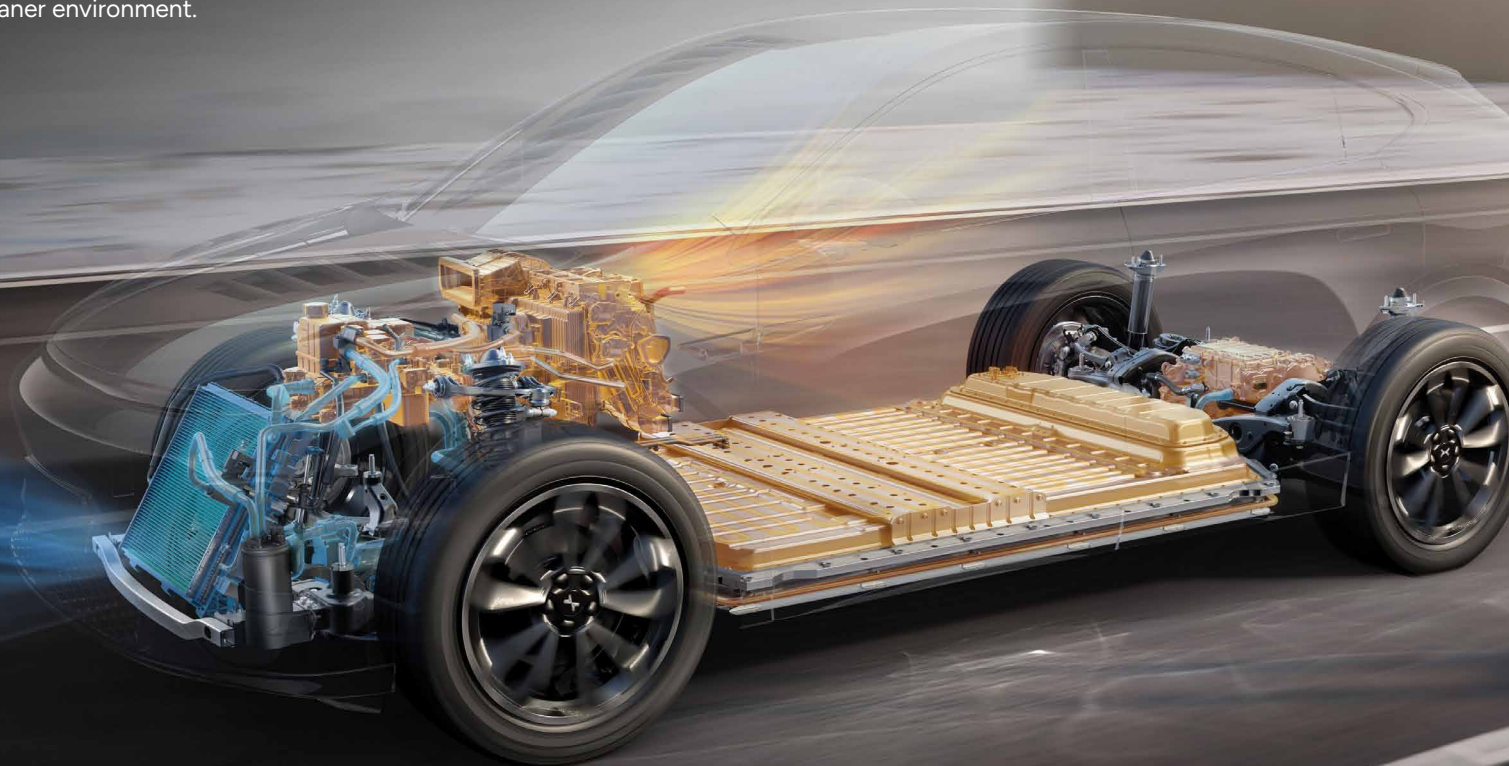



SMART CABIN EXPERIENCE

Full-Car Voice Activation: Fast, multi-zone voice control across cockpit functions — even from the rear seats.

9 inch, full view streaming media rearview mirror: available in Long Range and Performance.

Built in Dashcam: Available in RWD long range and AWD Performance. The vehicles parking and sentry cameras act as a dashcam.



18-SPEAKER XOPERA SOUND SYSTEM

All 18 speakers (including 2 driver seat stereos) are equipped with the Xopera sound system, which has been masterfully tuned, 7.1.4 panoramic effective technology, and self-developed acoustic algorithms to create mind-blowing sound effects.

01

Three-layer composite paper cone speakers

- "Sandwich" structure, paper + EPP + paper, the upper layer of high-end materials has beautiful appearance and texture; the middle layer of EPP material is lightweight, good damping; the bottom layer of composite pulp has a high degree of rigidity, solid support.

- Effectively ensure that the bass is elastic, deeper and more infectious sound.

02

KEVLAR diaphragm speaker

- Bulletproof fiber material, outstanding transient response; tone is more fluid, natural, and layered. Ideal for fast-paced songs with rapid and frequent changes in tone and volume.

03

Titanium membrane speaker

- Fine and transparent treble, good metallic performance, clear tone, especially in the appreciation of symphonic music and pop tunes, the effect is better.

04

Spatial sound 2.0, building the cockpit surround sound effect

- Based on the theory of psychoacoustic binaural localization of the sound source, the position and orientation of each speaker are optimized to broaden the sound's width.

- Each occupant of the vehicle can feel the "emperor position" of listening delight thanks to the 7.1.4 panoramic sound effect technology, which increases the degree of music extension and thus the sound field.

05

Lossless restoration algorithms for the highest possible quality of any type of music

- Repairing lossy music with the player's low bit rate to achieve lossless-like sound quality, which can improve the sound quality of digitally compressed audio.

- The vehicle reproduces the original sound by compensating the sound field and recovering the high-frequency sound, allowing every type of regular music to be delivered in flawless increases the degree of music extension and thus the sound field.

06

Vocal beautification algorithms, as if you were listening live

• Improved some of the vocal overtones for a more genuine and intimate sound signature.

• A more immersive vocal image and richer vocal expression without distorting the sound.





12 - way power adjustable driver seat

Featuring industry-leading intelligent comfort configurations, including 8-way power adjustment + 4-way lumbar support, multi-directional tensile surfaces to fit ergonomic curves. Enjoy heated and ventilated seats as standard, Long Range and Performance come with massage functions.

6 - way power adjustable passenger seat

Treat your driving companions to ultimate comfort with heated and ventilated seats as standard, plus massage functions available in Long Range and Performance.

12 - position backrest adjustable rear seat

Comes with the ability to tilt and recline, the backrest can be adjusted from 27° to 38.4°, offering 12 manual adjustment options. Whether you're seating family or friends, the rear seats can be tailored to provide the ideal position for relaxation, with the flexibility to lie back or sit upright for maximum enjoyment.



VERSATILE STORAGE SOLUTIONS

571L (1374L with rear seats folded) rear trunk + center console with underfloor stowage for everyday utility.



Steering Wheel Functions

Four-way adjustable heated leather steering wheel as standard.

Quickly access frequently used features including auto-parking and cruise control from the customisable button on the steering wheel.

The scroll control on the left spoke enables raising or lowering the temperature, and engages the air-con automatically if off. You can also control air flow without touching the screen.

Navigate back from Apple CarPlay or Android Auto to the XPENG dashboard with the back button, as well as activating voice control and controlling volume.

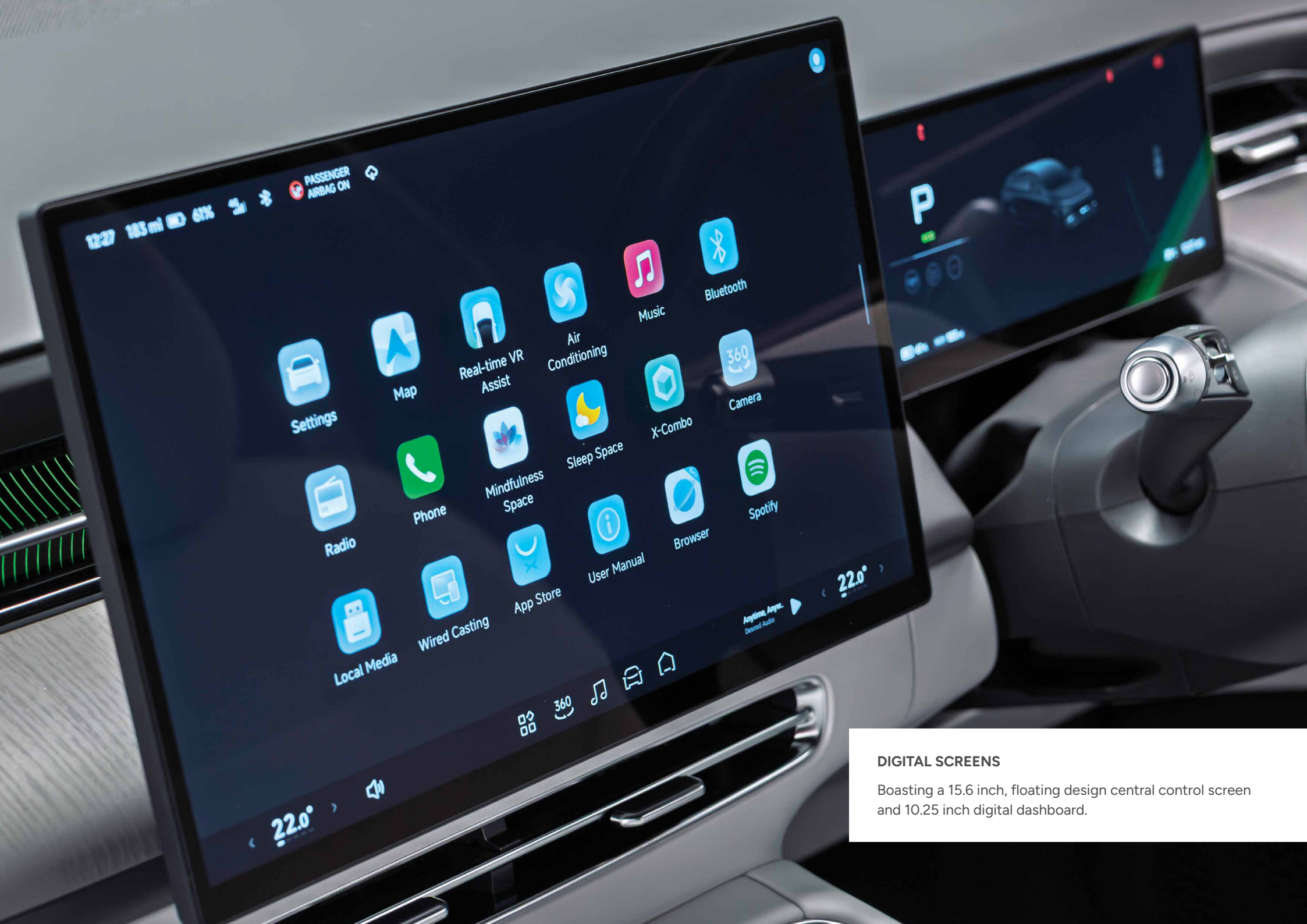

DIGITAL SCREENS

Boasting a 15.6 inch, floating design central control screen and 10.25 inch digital dashboard.

VEHICLE WARRANTY

Vehicle
5-Year / 120,000
Kilometer Warranty

Drive confidently knowing you're backed by a robust manufacturer warranty that covers your vehicle for five years or up to 120,000 kilometer - whichever comes first. It's our promise of quality and reliability.

Battery
8-Year / 160,000
Kilometer Warranty

Hit the road with confidence, knowing your battery is protected by an eight-year or 160,000-kilometer warranty - whichever comes first. This coverage reflects our commitment to advanced technology, long-term performance, and the dependable quality you expect from XPENG.

Body
12-Year / Unlimited
Mileage Warranty

Our 12-year, unlimited mileage anti-corrosion warranty protects against corrosion and perforation, ensuring long-term durability. It's part of our commitment to quality and reliability - so you can focus on the road ahead, not what's under the surface.

Service Intervals
1-Year / 20,000
Kilometer

Keep your XPENG performing at its peak with routine servicing recommended every 20,000 kilometer or one year - whichever comes first. Regular maintenance helps ensure long-lasting reliability and the smooth, worry-free driving experience you expect.

XPENG G6 — Specification Sheet

RWD Standard Range · RWD Long Range · AWD Performance

SPECIFICATION	RWD Standard Range	RWD Long Range	AWD Performance
Wheelbase (mm)	2890	2890	2890
Track width (front/rear)	1635/1650	1635/1650	1635/1650
Number of Seats	5	5	5
Curb Weight (kg)	2065 without tow bar 2085 with tow bar	2115 without tow bar 2140 with tow bar	2220 without tow bar 2240 with tow bar
Gross Vehicle Mass (GVM) (kg)	2535	2590	2690
Maximum payload (kg)	470 without tow bar 450 with tow bar	475 without tow bar 450 with tow bar	470 without tow bar 450 with tow bar
Trunk Space (L)	571L (1374L with rear seats folded)	571L (1374L with rear seats folded)	571L (1374L with rear seats folded)
Luggage rack load (kg)	75		
Electric towing hook capacity (kg)	Vertical 75 Horizontal 1500 (with brake) /750 (without brake)	Vertical 75 Horizontal 1500 (with brake) /750 (without brake)	Vertical 75 Horizontal 1500 (with brake) /750 (without brake)
Dimensions (mm)	Length 4,753 Width 1,920 Height 1,650	Length 4,753 Width 1,920 Height 1,650	Length 4,753 Width 1,920 Height 1,650
COMPREHENSIVE PERFORMANCE			
Drivetrain	RWD	RWD	AWD
Power output (kW)	185	218	358
Power output (HP)	248	292	480
Torque (N·m)	440	440	660
Top Speed (km/h)	202	202	202
Acceleration (0~100km/h) (s)	6.94	6.7	4.13
Turning radius (m)	5.8	5.8	5.8
Cell Type	LFP L300	LFP L300	LFP L300
Gross battery capacity (kWh)	68.5	80.8	80.8
WLTP Driving Range (km)	480(R18)	535(R18)	510(R20)
NEDC Driving Range (km)	550(R18)	615(R18)	575(R20)
Energy consumption kwh/100km-WLTP	16.6(R18)	17.5(R18)	18.4(R20)
Energy consumption kwh/100km-NEDC	14.4(R18)	15.2(R18)	16.3(R20)
Charging port type	European standard CCS2; Central Asian models: standard CN GB	European standard CCS2; Central Asian models: standard CN GB	European standard CCS2; Central Asian models: standard CN GB
AC charging power (kW)	EU 11kw	EU 11kw	EU 11kw
AC charging time (5~100%) h	7.3	9.2	9.2
DC Max charging power (kW)	382	451	451
DC charging time (10~80%)	12mins SOC 10%-80%	12mins SOC 10%-80%	12mins SOC 10%-80%

SPECIFICATION	RWD Standard Range	RWD Long Range	AWD Performance
· Intelligent High Beam IHB	•	•	•
· Driving Recorder	•	•	•
· Driver State Monitoring (DSM)	—	•	•
· XGuard	•	•	•
SIDE COLLISION PREVENTION			
· Blind Spot Detection (BSD)	•	•	•
· Door Open Warning (DOW)	•	•	•
· Lane Departure Warning (LDW)	•	•	•
· Emergency Lane Keeping (ELK)	•	•	•
· Lane Keep Assistance (LKA)	•	•	•
REAR COLLISION PREVENTION			
· Rear Collision Warning (RCW)	•	•	•
· Rear Cross-Traffic Alert (RCTA)	•	•	•
XOS			
HARDWARE			
Digital dashboard (inch)	10.25	10.25	10.25
Central control screen (inch)	15.6	15.6	15.6
UWB ultra-wideband smart remote control key	•	•	•
NFC card key	•	•	•
SOFTWARE			
"Hey XPENG" voice assistant	4 zone, full-scenario voice assistant with intelligent recommendation	4 zone, full-scenario voice assistant with intelligent recommendation	4 zone, full-scenario voice assistant with intelligent recommendation
Smart Navigation	-	-	-
DAB + FM radio	•	•	•
App store	•	•	•
Apple Carplay	•	•	•
Android Auto	•	•	•
Welcome Mode	•	•	•
Meditation Mode	•	•	•

SPECIFICATION	RWD Standard Range	RWD Long Range	AWD Performance
Suspension System	Front double wishbone independent suspension and rear five-link independent suspension	Front double wishbone independent suspension and rear five-link independent suspension	Front double wishbone independent suspension and rear five-link independent suspension
Drive mode	ECO Mode, Comfort Mode, Sport Mode, Individual Mode, Launch Mode, Escape Mode	ECO Mode, Comfort Mode, Sport Mode, Individual Mode, Launch Mode, Escape Mode	ECO Mode, Comfort Mode, Sport Mode, Individual Mode, Launch Mode, Escape Mode
OneBox Braking System	Front and Rear Ventilated Braking Discs	Front and Rear Ventilated Braking Discs	Front and Rear Ventilated Braking Discs
Drag Coefficient	0.248 Cd		
XPILOT ASSIST (ADVANCED DRIVER ASSISTANCE SYSTEM)			
HARDWARE SYSTEM			
Intelligent driving chip single Orin	—	•	•
Front-view integrated machine	•	—	—
XPILOT ASSIST DRIVING			
Adaptive Cruise Control (ACC)	•	•	•
Lane Centering Control (LCC)	•	•	•
Adaptive Turning Cruise (ATC)	•	•	•
Auto Lane Change (ALC)	—	•	•
XPILOT ASSIST PARKING			
Enhanced Auto Parking Assist (EAP2.0)	•	•	•
Parking assist with 360° camera	•	•	•
Transparent Chassis	•	•	•
Vehicle backup camera	•	•	•
XPILOT ASSIST SAFETY			
FORWARD COLLISION PREVENTION			
· Forward Distance Monitoring (FDM)	•	•	•
· Forward Collision Warning (FCW)	•	•	•
· Autonomous Emergency Braking (AEB)	•	•	•
· Traffic Sign Recognition (TSR)	•	•	•
· Speed assistant system (SAS)	•	•	•

SPECIFICATION	RWD Standard Range	RWD Long Range	AWD Performance
Voice control	•	•	•
Over-the-air (OTA) software updates	•	•	•
EXTERIOR			
LED Auto-sensing high beams and Dipped Headlights	•	•	•
LED Auto On/Off Headlights	•	•	•
Manual headlight height adjustment	•	•	•
Electric release door open button	•	•	•
Hidden door handles	•	•	•
Rain sensing automatic wiper	•	•	•
External rearview mirror (with electric folding/heating/memory/blind spot monitoring)	•	•	•
Soundproof glass (front windshield/first row)	•	•	•
Privacy glass (second row/rear windshield)	•	•	•
Four-door glass one-touch lifting with anti-pinch function	•	•	•
Panoramic skylight-free sunshade with heat insulation layer	•	•	•
Heated front windshield	•	•	•
18-inch wheels	•	•	-
20-inch wheels	-	-	•
INTERIOR			
Capacitive steering wheel-MicroFiber	•	•	•
USB Type-A*1	2.5W (Charging)	2.5W (Charging)	2.5W (Charging)
USB Type-C*3	1 (60W,support data transmission) + 2 (15W. charging ports)	1 (60W,support data transmission) + 2 (15W. charging ports)	1 (60W,support data transmission) + 2 (15W. charging ports)
Wireless charging with ventilation*2	50W *2	50W *2	50W *2
Streaming media rearview mirror	Manual anti-glare	Streaming media mirror	
Ambient light colors Number	256	256	256
Leather seats	•	-	-
Nappa leather + suede ceiling pillars	-	•	•
SOUND SYSTEM			
XPENG XOPERA Surround Sound System (16 speakers)	•	•	•
Driver seat speakers (seat shoulders)*2	•	•	•
AIR-CONDITIONING & HEAT PUMP			
Automatic air conditioning & heat pump air conditioning	•	•	•

SPECIFICATION	RWD Standard Range	RWD Long Range	AWD Performance
PM2.5 filtration/monitoring and display	•	•	•
In-car air purification system - N.95 filtration & pollen filtration	•	•	•
XHP 3.0 Intelligent Thermal Management System with heat pump	•	•	•
FIRST ROW SEATS			
Driver seat electric adjustment	•	•	•
Front passenger seat electric adjustment	•	•	•
First Row Seat 4-way Lumbar Support Adjustment	•	•	•
Front seats Heating	•	•	•
Front seats ventilation	•	•	•
Front seats lumbar support	•	•	•
Seat position memory/welcome function	•	•	•
Massage for front seats	-	•	•
SECOND ROW SEATS			
Second row seat backrest manual adjustment	•	•	•
Foldable rear seats (60/40)	•	•	•
Second row seat heating	•	•	•
Second row seat center armrest/armrest cup holder	•	•	•
SAFETY			
Tire-pressure monitoring system (TPMS)	•	•	•
Seat belt fastening reminder	•	•	•
Rear ISOFIX®	•	•	•
Acoustic Vehicle Alerting System (AVAS)	•	•	•
Autohold	•	•	•
Driver Airbags	•	•	•
Driver side airbags - far side airbag	•	•	•
Passenger Airbags	•	•	•
Front row side airbags	•	•	•
Front-to-rear side curtain airbags	•	•	•
EXTERIOR COLOUR			
Arctic White	•	•	•
Graphite Gray	•	•	•
Midnight Black	•	•	•
Silver Frost	•	•	•
Stellar Purple	•	•	•
Black Edition	-	-	•
INTERIOR COLOUR			
Dark Gray	•	•	•
Light Gray	•	•	•



This document is for informational purposes only. Images are for illustrative purpose only. Specifications may vary and are subject to updates or correction.

Range figures shown are combined WLTP and can vary significantly depending on factors such as grade, accessories fitted, driving style, weather conditions, speed or vehicle load.